

# PROGRAM



**69th ANNUAL MEETING**

**Southern Region**  
of the  
**American Society for Horticultural Science**

**January 31 to February 2, 2009**  
**Atlanta, GA**

## **Southern Region ASHS**

The Southern Region ASHS is a regional scientific society of the American Society for Horticultural Science. The Southern Region encompasses the 14 southern states of Texas, Louisiana, Oklahoma, Arkansas, Mississippi, Georgia, Alabama, Florida, South Carolina, North Carolina, Virginia, West Virginia, Kentucky and Tennessee. Membership varies over the years from about 400 to 500 active members. Membership is composed of research scientists, teachers and extension specialist from Universities, State, Federal and private research organizations, and industry. The Southern Region also contains a student section, the Association of Collegiate Branch, which is composed of student clubs from Departments of Horticulture and Plant Science across the region. The main focus of the Southern Region is the Annual Meeting, which is held every February in conjunction with the Southern Association of Agricultural Scientists (SAAS). The Annual Meeting consist of presentations of scientific papers, student paper competitions and judging contest, commodity group meetings, and awards presentations.

### **Goals:**

- **Encourage and facilitate the mutual exchange of ideas and information concerning horticultural research, extension, education, and industry in the south**
- **Promote stronger bonds among horticulturists in the southern regions**
- **Encourage participation in the national society of the American Society for Horticultural Science**
- 

**The Southern Region ASHS is recognized widely as the strongest and most active Region of the American Society for Horticultural Science, and has a history that goes back to 1920! Join us and become a part of the Tradition.**

### **President**

**Doug Bailey**

Dept. of Horticulture  
University of Georgia  
1111 Miller Plant Sci...  
Bldg.  
Athens, GA  
30602-7273

Phone: (706) 542-2471  
Fax: (706) 542-0624  
dabailey@uga.edu

### **President-Elect**

**Jim Ballington**

Dept. of Horticulture  
North Carolina State Univ.  
Box 7609  
Raleigh, NC  
27695-7609

Phone: (919) 515-1214  
Fax: (919) 515-2505  
jim\_ballington@ncsu.edu

### **Secretary-Treasurer**

**David Wm. Reed**

Dept. of Horticultural Sci.  
Texas A&M University  
College Station, TX  
77843-2133

Phone: (979) 845-0139  
Fax: (979) 845-0627  
dwreed@tamu.edu

**Web Site**  
**[srashs.org](http://srashs.org)**  
**Visit It**

# PROGRAM

## 69th ANNUAL MEETING

### Southern Region

### American Society for Horticultural Science

## SPECIAL EVENTS AND SESSIONS

### SATURDAY, JANUARY 31, 2009

- |                             |  |
|-----------------------------|--|
| <b>7:00 am - 6:00 pm</b>    | <b>Registration</b><br>Presiding: Dave Reed<br>Room: Hotel, Lobby  |
| <b>8:00 am - 5:00 pm</b>    | <b>Pecan Research and Extension Forum</b><br>Presiding: Lenny Wells<br>Room: International Room E                                  |
| <b>8:00 am - 5:00 pm</b>    | <b>National Sweetpotato Collaborators</b><br>Presiding: ?<br>Room: International Room F  |
| <b>8:00 am - 5:00 pm</b>    | <b>Southern Blueberry/Small Fruit Workers</b><br>Presiding: Joe Masabni<br>Room: International Room G                              |
| <b>10:00 am - 11:30 pm</b>  | <b>ACB Program, Share Club Activities and Refreshments</b><br>Presiding: Dustin Blue, ACB President<br>Room: International Room B  |
| <b>12:00 noon - 1:30 pm</b> | <b>ACB Group Lunch</b><br>Presiding: Dustin Blue, ACB President<br>Room: International Room B or TBA                               |
| <b>1:30 pm - 4:00 pm</b>    | <b>ACB Activities and/or Tour:</b><br>Presiding: Dustin Blue, ACB President<br>Room: International Room B or TBA                   |
| <b>1:00 pm - 5:00 pm</b>    | <b>Horticulture Administrators</b><br>Presiding: David Williams<br>Room: Boardroom   |
| <b>5:00 pm - until</b>      | <b>ACB Reception and Mixer</b><br>Presiding: Dustin Blue, ACB President<br>Room: International Room B or TBA                       |
| <b>5:00 pm - 6:00 pm</b>    | <b>Southern Region - ASHS Executive Committee Meeting</b><br>Presiding: Mike Arnold, Chair, Executive Committee<br>Room: Boardroom |

### SUNDAY, FEBRUARY 1, 2009

- |                           |   |
|---------------------------|---|
| <b>7:00 am - 6:00 pm</b>  | <b>Registration</b><br>Presiding: Dave Reed<br>Room: International Balcony (L6) |
| <b>8:00 am - 12:00 pm</b> | <b>Set up Posters</b>   |

		Presiding: Christine Coker Room: The Overlook Room
<b>8:00 am – 12:00 noon</b>		<b>J. Benton Storey Horticulture Judging Contest Setup</b> Presiding: Leo Lombardini, ACB Advisor Room: Agusta I
<b>8:00 am - 10:00 am</b>		<b>Extension Section</b> Presiding: David Lockwood Room: International Room G
<b>8:00 am - 5:00 pm</b>		<b>National Sweetpotato Collaborators</b> Presiding: ? Room: International Room F
<b>8:00 pm - 5:00 pm</b>		<b>Watermelon Research Group</b> Presiding: Steve King Room: International Room D
<b>8:00 am - 9:15 am</b>		<b>J. B. Edmond Undergraduate Student Paper Competition</b> Presiding: Dustin Blue, ACB President Doug Bailey, SR-ASHS President Mike Arnold, Section Chair & Judging Coordinator Room: International Room E
<b>9:00 am – 12:00 noon</b>		<b>Vigna Crops Germplasm Committee</b> Presiding: Richard Fery Room: International Room C
<b>9:15 am - 1:30 pm</b>		<b>Norman F. Childers M.S. Student Paper Competition</b> Presiding: Jim Ballington, President Elect TBA, Judging Coordinator Room: International Room E
<b>12:00 noon - 5:00 pm</b>		<b>Poster Session Viewing</b> Room: The Overlook Room
<b>1:00 pm - 5:00 pm</b>		<b>National Cowpea Improvement Association</b> Presiding: Bill Evans Room: International Room C
<b>1:00 pm - 5:00 pm</b>		<b>J. Benton Storey Horticulture Judging Contest</b> Presiding: Leo Lombardini, ACB Advisor Room: Agusta I
<b>3:00 pm - 5:00 am</b>		<b>Education Section</b> Presiding: Brian Kahn Room: International Room G
<b>1:30 pm - 3:00 pm</b>		<b>Warren S. Barham Ph.D. Student Paper Competition</b> Presiding: Jim Ballington, President Elect TBA, Judging Coordinator Room: International Room E
<b>1:00 pm - 2:30 pm</b>		<b>Poster Session - Authors at Posters</b> 1:00 pm - 1:45 pm even numbered posters 1:45 pm - 2:30 pm odd numbered posters
<b>2:30 pm - 3:30 pm</b>		<b>Poster Session - Student at posters for judging</b> Presiding Christine Coker Judging Coordinator Room: The Overlook Room

**SAAS Program**

- 3:30 pm - 5:00 pm SAAS General Session**  
 Presiding: Jimmy Cheek, President SAAS  
 Room: Vinings I and II  
 Title/Speaker: TBA
- 5:00 pm SAAS Reception and Super Bowl Party**  
 Room: Peachtree Ballroom

**MONDAY, FEBRUARY 2, 2009**

- 7:00 am - 10:00 am Registration**  
 Presiding: Dave Reed  
 Room: International Balcony (L6)
- 8:00 pm - 11:00 pm Poster Session Viewing**  
 Room: The Overlook Room
- 8:00 am - 10:45 pm Vegetable Crops Section**  
 Presiding: Terry Kelley  
 Room: International Room F
- 8:00 am - 10:30 pm Fruit Crops Section**  
 Presiding: Eric Stafne  
 Room: International Room G
- 8:00 am - 10:00 am Floriculture, Ornamentals and Turf Section**  
 Presiding: Ed Bush  
 Room: International Room E
- 8:00 am - 10:45 am Postharvest/Biotechnology/Plant Biology Section**  
 Presiding: Elizabeth Baldwin  
 Room: Tower Room 1403
- 9:00 am - 10:45 am ACB Business Meeting**  
 Presiding: Dustin Blue, ACB President  
 Room: International Room D
- 11:00 am - 12:30 pm Annual Business Meeting and Award Program**  
 Presiding: Doug Bailey, President  
 Room: International Room D
- 1:00 pm - 3:00 pm Vegetable Crops Section – Concurrent Session A**  
 Presiding: Terry Kelley  
 Room: International Room F
- 1:00 pm - 3:00 pm Vegetable Crops Section – Concurrent Session B**  
 Presiding: ?  
 Room: International Room E
- 1:00 pm - 2:00 pm Fruit Crops Section**  
 Presiding: Eric Stafne  
 Room: International Room G
- 1:00 pm - 4:00 pm Poster Session Take Down**
- SAAS Program: Ag Renewable Energy Opening Session and Symposium**  
**10:00 pm** Where has all the Money Gone (Ag Econ)  
**1:00 pm** Technical/Academic Papers (Rural Sociology)  
**3:00 pm** Take it to the Market (Ag. Comm)

# SECTION TITLES

**SUNDAY, FEBRUARY 1, 2009**

**J. B. EDMOND**

## UNDERGRADUATE STUDENT PAPER COMPETITION

**Room:** International Room E  
**Presiding:** Dustin Blue, President, ACB  
 Doug Bailey, President, Southern  
 Region ASHS  
 Mike Arnold, Section Chair, Judging  
 Coordinator

**Abstracts:** To publish abstract in *HortScience*, see instructions at end of program. Submit on disk at meeting or email to Chair: (ma-arnold@tamu.edu)

**8:00 am –9:15 am** Order of presentations determined by drawing at beginning of contest.

**Amending Pine Bark Supplies with Whole Tree and Clean Chip Residual.** Murphy, A.M.,\* C.H. Gilliam, G.B. Fain, T.V. Gallagher, and H.A. Torbert, Department of Horticulture, Auburn University, Auburn, AL 36849. (murphan@auburn.edu)

**Can Honey be used as an auxin substitute for rooting cuttings?** Erin E. Melville\*, Weiguang Yi, and Hazel Y. Wetzstein. Department of Horticulture, 1111 Miller Plant Science, University of Georgia, Athens, GA 30602-7272. (hywetz@uga.edu)

**Interesting Edibles: Designing an Edible Ornamental Garden for the Cliffs Botanical Garden.** Tina Musco\*, Renee K. Byrd, and Mary Taylor Haque. Department of Horticulture, Clemson University, Clemson, SC 29634. (jkeydos@clemson.edu)

## NORMAN F. CHILDERS M.S. GRADUATE STUDENT PAPER COMPETITION

**Room:** International Room E  
**Presiding:** Jim Ballington, President-Elect,  
 Southern Region ASHS

**Abstracts:** To publish abstract in *HortScience*, see instructions at end of program. Submit on disk at meeting or email to Chair: (jim\_ballington@ncsu.edu)

**9:15 am – 1:30 pm** Order of presentations determined by drawing at beginning of contest.

**Agrobacterium Transformation of Poinsettia (*Euphorbia pulcherrima*).** Dinum Perera\*. Department of Horticulture, Mississippi State University, Starkville, MS. 39762. (hnp21@msstate.edu)

**Changes in Edible Quality and Aroma Profile of ‘Arkin’ carambola Fruit During Ripening on the Tree.** Oren Warren\*, Steven Sargent, Anne Plotto and Elizabeth Baldwin,. University of Florida, 1301 Fifield Hall, Gainesville, FL 32611. (owarren@ufl.edu)

**Effect of Sowing Depth and Soil Type on Germination and Initial Growth of Three Native Wildflower Species.** Laureanne Bond\*, Amy N. Wright and E. A. Guertal. Departments of Horticulture and Agronomy and Soils, Auburn University, Auburn, AL 36849. (bondlau@auburn.edu)

**Effects of High Tunnels and Cane-Mowing Regimen on the Growing Degree Unit Response and Requirements of Primocane-Fruiting Blackberries.** Christopher I. Vincent\*, Curt R. Rom and M. Elena Garcia. Department of Horticulture, University of Arkansas, Fayetteville, AR 72701. (civince@uark.edu)

**Effects of short Cyclic Flooding on Growth and Physiology of Selected Native Shrubs.** Katie Werneth\* and Amy N. Wright. Department of Horticulture, Auburn University, Auburn, AL, 36849 (wernekl@auburn.edu)

**Evaluation of Fertility in Floricane- and Primocane-Fruiting Blackberry (*Rubus L. spp.*) Genotypes.** Alisha Ruple\*, John R. Clark and M. Elena Garcia. Department of Horticulture, University of Arkansas, Fayetteville, AR, 72701. (aruple@uark.edu)

**Fertilizer Recommendations for Alternative Substrates.** Whitney Griffin\*, Glen Fain, Charles Gilliam, Donald J. Eakes, Jeff Sibley and Ben Richardson. Department of Horticulture, Auburn University, Auburn, AL, 36849, and Farm Links Nursery, Sylacauga, AL 35151.

**Identification of Tannins from Pecan Kernals by Liquid Chromatography-Mass Spectrometry.** Ana Gabriela Ortiz-Quezada\*, Leonardo Lombardini and Luis Cisneros-Zevallos. Department of Horticultural Sciences, Texas A&M University, College Station, TX, 77843-2133. (ago@tamu.edu)

**Landscape Irrigation Scheduling for *Hydrangea quercifolia* ‘Alice’ and *Rhododendron austrinum*.** Abby Bailey\* and Amy N. Wright. Department of Horticulture, Auburn University, Auburn, AL, 36849. (Baileal@auburn.edu)

**Organic Matter Type Affects Post-Transplant Root Growth of Selected Native Shrubs in a Simulated Above-Grade Planting Technique.** Scott B. Hanes\* and Amy N. Wright. Department of Horticulture, Auburn University, Auburn, AL, 36849. (sbh0003@auburn.edu)

**Phytotoxicity of Deer Repellents on Landscape Plants.** Ashley Baker\*, Glen B. Fain, Christine Coker, Steve Ditchkoff, and Donald J. Eakes. Departments of Horticulture and Wildlife Science, Auburn University, Auburn, AL, 36849, and Coastal Research and Extension Center, Mississippi State University, Biloxi, MS, 39532. (bakerl3@auburn.edu)

**Planning, Designing and Growing an Educational Green Roof to Demonstrate Water Quality Protection at Friends of Lake Keowee Society Headquarters.** Erin L. Cooke\*, Christa D. Jordan\*, Mary Haque and Jeff Adelberg. Department of Horticulture, Clemson University, Clemson, SC 29631. (elcooke@clemson.edu)

**Reproductive Biology of *Elliottia racemosa*, a Rare Coastal Plain Endemic.** Carrie A. Radcliffe\*, James A. Affolter and Hazel Y. Wetstein. Department of Horticulture, University of Georgia, Athens, GA 30602-7273. (hywetz@uga.edu)

**Watermelon (*Citrullus lanatus*) Grafting Method Reduces Labor Costs and Eliminate Rootstock Side Shoots.** Fredrick D. Memmott\* and Richard L. Hassell. Clemson University Coastal Research and Extension Center, Charleston, SC 29414. (fmemmot@clemson.edu)

## WARREN S. BARHAM Ph.D. GRADUATE STUDENT PAPER COMPETITION

**Room:** International Room E  
**Presiding:** Jim Ballington President-Elect, Southern Region ASHS  
**Abstracts:** To publish abstract in *HortScience*, see instructions at end of program. Submit on disk at meeting or email to Chair: (jim\_ballington@ncsu.edu)

**1:30 pm – 3:00 pm** Order of presentations determined by drawing at beginning of contest.

**A Microarray Approach to Identify Candidate Genes for Internal Heat Necrosis in Potato.** Per H. McCord\*, G. Craig Yencho and Bryon Sosinski. Horticultural Science Department, North Carolina State University, Raleigh, NC 27695. (phmccord@ncsu.edu)

**Determination of the Optimal Ripeness Stage for Processing ‘Kent’ Mango into Fresh-Cut Slices.** Sharon Dea\* Jeffery K. Brecht and Cecilia N. Nunes, University of Florida, 1301 Fifield Hall, Gainesville, FL 32611. (shdea@ufl.edu)

**Genetic and Quantitative Analysis of Red Raspberry (*Rubus idaeus* L.): Heat Tolerance and Using Chlorophyll Fluorescence to Assess Heat Stress.** Ramon Molina Bravo\*, Gina E. Fernandez and Bryon Sosinski. Horticultural Science Department, North Carolina State University, Raleigh, NC 27695. (rmolina2@ncsu.edu)

**Pre-Storage Conditioning of NMF Peaches Using Directed Heat Stress Combined with 1-MCP to Maintain Appealing Sensory Characteristics During Postharvest Handling.** Ming Wei Kao\*, Donald J. Huber and Jeffery K. Brecht, University of Florida, 1301 Fifield Hall, Gainesville, FL 32611. (jkbrecht@ufl.edu)

## EXTENSION SECTION

**Room:** International Room G

**Presiding:** David Lockwood

**Abstracts:** To publish abstract in *HortScience*, see instructions at end of program. Submit on disk at meeting or email to Chair: (dlockwood@utk.edu)

**8:00 am Solving the Puzzle: Dealing With a New Pest,** Adrian Hunsberger\*<sup>1</sup>, Catherine Mannion<sup>2</sup>, Henrique Mayer<sup>1</sup>, Mary Lamberts<sup>1</sup>, and Ruben Regalado<sup>1</sup>, <sup>1</sup>University of Florida/IFAS Miami-Dade Extension, 18710 SW 288th Street, Homestead, FL 33030, <sup>2</sup>University of Florida/IFAS Tropical Research & Education Center, 18905 SW 280 Street, Homestead, FL 33031. (aghu@ufl.edu)

**8:15 am Responding to Growers' Needs for Worker Protection Standards Training,** Mary Lamberts\* and Ruben Regalado, UF Miami-Dade County Extension and Sonia Cotto Febo, Florida Department of Agriculture & Consumer Service. (lamberts@ifas.ufl.edu)

**8:30 am Web-based Student Evaluation of the**

**Oklahoma Grape Management Short Course**, Eric T. Stafne\*<sup>1</sup>, William G. Mc Glynn<sup>1</sup>, and Phillip G. Mulder, Jr.<sup>2</sup>,  
<sup>1</sup>Department of Horticulture and Landscape Architecture, Oklahoma State University, Stillwater, OK 74078,  
<sup>2</sup>Department of Entomology and Plant Pathology, Oklahoma State University, Stillwater, OK 74078.  
 (eric.t.stafne@okstate.edu)

**8:45 am Helping New Growers Gear-up for Production of Fresh Produce**, Lynn Brandenberger\*<sup>1</sup>, Steve Upson<sup>2</sup>, Eric Stafne<sup>1</sup>. <sup>1</sup>Department of Horticulture, Oklahoma State University, Stillwater, OK 74078, <sup>2</sup>Cropping Systems, Sam Noble Foundation, Ardmore, OK. (lbp@okstate.edu)

**9:00 am break**

**9:15 am Finding the Forest in the Trees: Using GPS Technology to Train Master Gardeners for Urban Tree Inventories**, David Berle, Department of Horticulture, University of Georgia, Athens, GA 30602-7273. (dberle@uga.edu)

**9:30 am Landscape Technician Certification for Prison Inmates in Florida**. Geoff Denny, Environmental Horticulture Department, University of Florida/IFAS Gulf Coast REC, 14625 C.R. 672, Wimauma, FL 33598. (gcdenny@ufl.edu)

**9:45 am Volunteer Management: Necessary Evil or Blessing in Disguise?** Marina D'Abreau, University of Florida/IFAS Hillsborough County Extension, 5339 County Rd. 579, Seffner, FL 33584-3334 (mdabreau@ufl.edu).

**10:00 am An IPM Scouting Program for Small Mixed Vegetable Farms: Providing Service to Amish and Mennonite Communities in Kentucky**, Timothy Coolong\* and Lucas Hanks, Department of Horticulture, University of Kentucky, Lexington, KY 40546-0091 (timcoolong@uky.edu).

## EDUCATION SECTION

**Room:** International Room G

**Presiding:** Brian Kahn

**Abstracts:** To publish abstract in *HortScience*, see instructions at end of program. Submit

on disk at meeting or email to Chair: (brian.kahn@okstate.edu)

**3:00 pm Challenges, Stratagems and Gratification of Teaching a Study Abroad Course in Horticulture to Non-major Students.** Leonardo Lombardini\*, Department of Horticultural Sciences, Texas A&M University, College Station, TX 77843-2133. (l-lombardini@tamu.edu)

**3:15 pm Studying Abroad in a College of Agricultural and Life Sciences – What do the Students Think?** Mark Rieger\*, College of Agricultural and Life Sciences, University of Florida, Gainesville, FL 32611-0270. (mrieger@ufl.edu)

**3:30 pm Transfer Planning Guides to Facilitate Articulation between Junior-college and Baccalaureate-level Horticulture Programs.** Brian A. Kahn\*, Department of Horticulture and Landscape Architecture, Oklahoma State University, Stillwater, OK 74078-6027. (brian.kahn@okstate.edu)

**3:45 pm General Education and General Interest Courses as Recruiting Tools for the Horticulture Undergraduate Programs.** Bala Rathinasabapathi\* and Rebecca Darnell, Horticultural Sciences Department, University of Florida, Gainesville, FL 32611-0690. (brath@ufl.edu)

**4:00 pm break**

**4:15 pm Turning Over a New Leaf: Creative Tools for Student Engagement and Recruitment in a Large-size Introductory Horticulture Class.** David Berle\*, Department of Horticulture, University of Georgia, Athens, GA 30602-7273. (dberle@uga.edu)

**4:30 pm A Preliminary Analysis of a Novel Horticulture Bachelor of Arts Degree Program.** Jayne M. Zajicek, Sharon A. Duray, R. Daniel Lineberger\* and Tim D. Davis, Department of Horticultural Sciences, Texas A&M University, College Station, TX 77843-2133. (dan-lineberger@tamu.edu)

**4:45 pm Impact of a Non-thesis Distance Graduate Program on Horticulture Enrollment: A Three Year Study.** C.B.



McKenney\*, Department of Plant and Soil Science, Texas Tech University, Lubbock, TX 79409-2122. (Cynthia.McKenney@ttu.edu)

## POSTERS

**Room:** The Overlook Room

**Presiding:** Christine Coker

**Abstracts:** To publish abstract in *HortScience*, see instructions at end of program. Submit on disk at meeting or email to Chair: (ccoker@ra.msstate.edu)

**Set-Up:** Sunday, 8:00 am –12:00 pm

**Poster Viewing** Sunday noon to Monday noon

**Authors at Poster:** Sunday

1:00 pm -1:45 pm even numbered posters

1:45 pm -2:30 pm odd numbered posters

**Students In Competition at Poster:** Sunday

2:30 pm -3:30 students at posters

**Take-down:** Monday, after Business Meeting

“G” or “U” following the poster number indicates graduate and undergraduate poster, respectively, for the National Cowpea Poster Competition. Undergraduate and Graduate students in the poster competition must be by their posters during the “Students in Competition at Poster” times.

### Floriculture, Ornamentals and Turf

**1G) Chemical Composition of the Medicinal Plant, *Marrubium vulgare* grown under greenhouse versus in vitro conditions.**

James W. Gegogaine\*, Weiguang Yi, and Hazel Y. Wetzstein. Department of Horticulture, 1111 Miller Plant Science Building, University of Georgia, Athens, GA 30602-7273. (hywetz@uga.edu)

**2G) Conserving Our Botanical Heritage: Using GPS/GIS to determine population dynamics of *Elliottia racemosa*.**

Justin A. Porter\*, David Berle, Hazel Y. Wetzstein. Department of Horticulture, 1111 Miller Plant Science Building, The University of Georgia, Athens, GA 30602. (japorter@uga.edu)

**3G) Influence of Four Rates of NaCl and CaCl<sub>2</sub>/KCl on Leaf Osmotic Potential and Nutrient Concentration in Three Genotypes of *Taxodium distichum*.**

Lijing Zhou\*, Dave Creech, Leon Young, and Dave Kulhavy. College of Forestry and Agriculture, Stephen F. Austin State University, Nacogdoches, TX 75962-3000. (zhaul@titan.sfasu.edu)

**4) Boston Fern Production in Whole Pine Tree Substrates.** Anthony L. Witcher<sup>1\*</sup>, James M. Spiers<sup>1</sup>, and Glenn B. Fain<sup>2</sup>, <sup>1</sup>USDA-ARS Southern Horticultural Lab, 810 Hwy. 26 West, Poplarville, MS 39470, <sup>2</sup>109 Funchess Hall, Auburn University, AL 36849. (Anthony.Witcher@ARS.USDA.GOV)

**5) Using Vermicompost in Container**

**Substrates.** Gary R. Bachman, MSU Coastal Research and Extension Center, 1815 Poppo Ferry Road, Biloxi, MS 38532 (gbachman@ext.msstate.edu)

**6) Growth Regulation of Loropetalum and Azalea with Flurprimidol in the Landscape.**

Yan Chen\*, Regina P. Bracy, and Allen Owings, LSU AgCenter Hammond Research Station, 21549 Old Covington Highway, Hammond, LA 70403 e-mail: (YaChen@agcenter.lsu.edu)

### Fruit Crops

**7) Determining Optimal Fertilizer Program During Peach Establishment Years in a High Density Orchard System.**

M. Elena Garcia\*, E. Stafne, D. Chapman, K. Woodburn, Qingfang Chen, and M. Carter. 310 Plant Sciences Bldg., University of Arkansas, Fayetteville, AR 72701. (megarcia@uark.edu)

**8) Survey of Pecan management and challenges within the Noble Foundation service area.**

Charles T. Rohla\* and Joshua W. Chaney, Agricultural Division, The Samuel Roberts Noble Foundation, Ardmore, OK 73401. (ctrohla@noble.org)

**9) Evaluation of Seven Mulching Treatments for Organic Rabbiteye Blueberry Production.**

G. Krewer<sup>1\*</sup>, M. Tertuliano<sup>2</sup>, J.E. Smith<sup>1</sup>, H. Scherm<sup>1</sup>, K. Plattner<sup>1</sup>, J. Clark<sup>1</sup>, J. Jacobs<sup>1</sup>, E. Andrews<sup>1</sup>, D. Stanaland<sup>1</sup>, T. Varnadore<sup>1</sup>, P. Andersen<sup>1</sup>, O. Liburd<sup>3</sup>, and G. Fonsah<sup>1</sup> <sup>1</sup>Univ. of Georgia, Tifton, Ga. 31793 or other locations, <sup>2</sup>Univ. of Florida, Quincy, Fla. 32351, <sup>3</sup>Univ. of Florida, Gainesville, Florida. 32611 (gkrewer@uga.edu)

**10) Recent Experiments Involving ‘Veinte Cohol’: A Short Cycle Banana For Fruit Production In Non-tropical Environments.**

Richard H. Wallace<sup>1\*</sup>, Gerard Krewer<sup>2</sup>, and Suzanne R. Carpenter<sup>1</sup>, <sup>1</sup>Department of Chemistry and Physics, Armstrong Atlantic

State University, Savannah, GA 31419,  
<sup>2</sup>Department of Horticulture, University of  
 Georgia-Tifton Campus, Tifton, GA 31793.  
 (richard.wallace@armstrong.edu)

- 11) **The effect of temperature stress on induction of flowering in olives.** Nasir. S. A. Malik\*. USDA-ARS, KGSRC, 2413 E. Hwy 83, Weslaco TX 78596. (Nasir.Malik@ARS.USDA.GOV)
- 12) **Bioactive compounds in organically grown pecan kernels.** Jose Perez\*. USDA-ARS, KGSRC, 2413 E. Hwy 83, Weslaco TX 78596. (Jose.Perez@ARS.USDA.GOV)

### Vegetable Crops

- 13) **Evaluation of fresh seed yield of southern pea genotypes in Southern Arkansas.** Sixte Ntamungiro\*, S.O. Okiror, and J. Davis. Department of Agriculture, University of Arkansas, Pine Bluff, AR 71601. (ntamungiros@uapb.edu)
- 14) **Effect of continuous and rotated crop sequences on vegetable production by limited resource farmers in Arkansas.** Sixte Ntamungiro\*, J. Davis, and J. Handcock. Department of Agriculture, University of Arkansas, Pine Bluff, AR 71601. (ntamungiros@uapb.edu)
- 15) **Efficacy of Foliar Sprays for Management of Downy Mildew of Winter Squash.** A.H. Beany<sup>1</sup>, K. Pernezny<sup>2</sup>, P. J. Stoffella<sup>1</sup>, and N. Havranek<sup>2</sup>. <sup>1</sup>University of Florida, IFAS, Indian River Research and Education Center, 2199 South Rock Road, Fort Pierce, Florida 34945-3138, USA. <sup>2</sup>University of Florida, IFAS, Everglades Research and Education Center, 3200 East Palm Beach Road, Belle Glade, Florida 33430-4702, USA. (ahbeany@ufl.edu)
- 16) **Phenotypic Variability in Hot Pepper (*Capsicum annuum* L.) Breeding Lines.** Mohammad Jalaluddin\* and Shahidul Islam, Department of Agriculture, University of Arkansas at Pine Bluff, Pine Bluff, AR 71601. (jalaluddinm@uapb.edu)

### Other

- 17) **Horticultural Therapy on the Mississippi Gulf Coast.** Christine E.H. Coker\*. Coastal Research and Extension Center, Mississippi State University, 1815 Popps Ferry Road, Biloxi, MS 39565. (ccoker@ra.msstate.edu)

- 18) **Using Suspension Culture System to Screen Plant Species for Phytoremediation.** Guochen Yang\*, Zhongge (Cindy) Lu, and Vestal Shirley, Department of Natural Resources and Environmental Design, North Carolina A&T State University, Greensboro, NC 27411 (yangg@ncat.edu)

## Monday, February 2, 2009

### POSTERS

- Room:** The Overlook Room  
**Presiding:** Christine Coker  
**Abstracts:** To publish abstract in *HortScience*, see instructions at end of program. Submit on disk at meeting or email to Chair: Chair (ccoker@ra.msstate.edu)  
**Poster Viewing** Monday 8:00-11:00 am  
**Take-down:** Monday, after Business Meeting

### ANNUAL BUSINESS MEETING AND WARDS PROGRAM

- Room:** International Room D  
**Time:** 11:00 – 12:30  
**Presiding:** Doug Bailey, President

### VEGETABLE CROPS SECTION

- Room:** International Room F  
**Presiding:** Terry Kelley  
**Abstracts:** To publish abstract in *HortScience*, see instructions at end of program. Submit on disk at meeting or email to Chair: r (wtkelley@uga.edu)

### Morning Session

- 8:00 am** **Tomato Yield and Quality for Commercial Production in Tennessee and Kentucky.** Annette L. Wszelaki<sup>1\*</sup>, Jose Vargas, Mary Rogers, Sarah Broughton, D.J. Mitchell and Timothy Coolong<sup>2</sup>, <sup>1</sup>Department of Plant Sciences, University of Tennessee, 252 Ellington Plant Sciences Bldg, 2431 Joe Johnson Dr., Knoxville, TN 37996, <sup>2</sup>Department of Horticulture, N-318 Agricultural Sciences North, University of Kentucky, Lexington, KY 40546. (annettew@utk.edu)
- 8:15 am** **The Best of Both Worlds: Bicolor Sweet Corn Varieties for the Grower and**

- Consumer.** Annette L. Wszelaki\*, Brad Fisher and Brent Smith, Department of Plant Sciences, University of Tennessee, 252 Ellington Plant Sciences Bldg, 2431 Joe Johnson Dr., Knoxville, TN 37996. (annettew@utk.edu)
- 8:30 am Transplant Cell Size Affects Transplant Size and Subsequent Broccoli Yield.** Juan C. Diaz-Perez\* and John Silvoy, Department of Horticulture, University of Georgia, Tifton Campus, P.O. Box 748, Tifton, GA 31793. (jcdiaz@uga.edu)
- 8:45 am Melon Grafting Eliminates Soil Fumigation and Improved Fruit Quality and Marketable Yield.** Richard L. Hassell\* and Frederic D. Memmott. Clemson University CREC, 2700 Savannah Highway Charleston, SC 29414 (rhassel@clemson.edu)
- 9:00 am Distribution of Tomato Fruit Sizes by Variety as Affected by Various Treatment Conditions Grown in the Greenhouse at Tifton, GA.** B.G. Mullinix<sup>1\*</sup>, S.G. Phatak<sup>2</sup> and J. Cooper. <sup>1</sup>Texas A&M University, AgriLife Research & Extension Center, 1102 FM 1294, Lubbock, TX 79403. <sup>2</sup>Department of Horticulture, University of Georgia, Tifton, GA 31793 (bgmullinix@ag.tamu.edu)
- 9:15 am Break**
- 9:30 am Practical Method for Irrigation Chlorination: Field Experiences with Lettuce and Tomato.** Christopher C. Gunter<sup>1\*</sup>, Jose Garzon<sup>1</sup>, Connie Fisk<sup>1</sup>, Trevor Phister<sup>2</sup>, Garry Grabow<sup>3</sup>, and Kelly Ivors<sup>4</sup>, <sup>1</sup>1230 Kilgore Hall, Box 7609, Department of Horticultural Science, North Carolina State University, Raleigh, NC 27695-7609, <sup>2</sup>2339-B Schaub Hall, Department of Food, Bioprocessing and Nutrition Sciences, North Carolina State University, Raleigh, NC, <sup>3</sup>202 Weaver Administration Building, Department of Agricultural and Biological Engineering, North Carolina State University, Raleigh, NC, <sup>4</sup>Department of Plant Pathology, North Carolina State University, Mountain Horticultural Crops Research and Extension Center, Mills River, NC. (chris\_gunter@ncsu.edu)
- 9:45 am The Effects of Pulsing Drip Irrigation on Tomato Yield and Quality.** Timothy Coolong, Department of Horticulture, N-318 Agricultural Sciences North, University of Kentucky, Lexington, KY 40546-0091. (tcool2@email.uky.edu)
- 10:00 am Effects of Colored Shade Cloth on Yield and Grade of Bell Pepper Grown in a High Tunnel.** William G. Sherrer\*, Wheeler G. Foshee, J. Raymond Kessler and James E. Brown, Department of Horticulture, Auburn University, Auburn University, AL 36849. (sherrwg@auburn.edu)
- 10:15 am Effect of Colored Plastic Mulches and Row Cover on the Growth and Production of Sweet Potato.** Danieal M. Sullen\*, James E. Brown, Floyd M. Woods, Edgar L. Vinson and Jason E. Burkett. 101 Funchess Hall, Department of Horticulture, Auburn University, Auburn University, AL 36849. (brownj6@auburn.edu)
- 10:30 am Influence of Plastic Mulch Color on Carotenoid Content and Antioxidant Properties in Sweet Potato.** Floyd M. Woods\*, Daniel Sullen, James E. Brown, Benjamin Blasius and Jason E. Burkett, 101 Funchess Hall, Department of Horticulture, Auburn University. Auburn University, AL 36849. (woodsfm@auburn.edu)
- Break Break to attend SR-ASHS Business Meeting at 11:00-12:30 and lunch**
- Concurrent Afternoon Session A**  
**Room: International Room F**  
**Presiding: Terry Kelley**
- 1:00 pm Two-Year Evaluation of Pepper Herbicides Applied Under Plastic.** Joseph G. Masabni<sup>1\*</sup>, Dwight E. Wolfe<sup>2</sup>. <sup>1</sup>221 HFSB, Department of Horticulture, Texas A&M University, College Station, TX 77843-2134, <sup>2</sup>University of Kentucky Research and Education Center, 1205 Hopkinsville St, Princeton, KY. (jmasabni@ag.tamu.edu)
- 1:15 pm Two-Year Evaluation of Sweet Sorghum Herbicides.** Joseph G. Masabni<sup>1\*</sup>, Dwight E. Wolfe<sup>2</sup>. <sup>1</sup>221 HFSB, Department of Horticulture, Texas A&M University, College Station, TX 77843-2134, <sup>2</sup>University of Kentucky

Research and Education Center, 1205 Hopkinsville St, Princeton, KY. (jmasabni@ag.tamu.edu)

**1:30 pm Organic Production of Vidalia Onions.**

George Boyhan<sup>1\*</sup>, Ray Hicks<sup>2</sup>, Reid Torrance<sup>3</sup>, Cliff Riner<sup>3</sup>, Randy Hill<sup>4</sup> and Denny Thigpen<sup>4</sup>, <sup>1</sup>Department of Horticulture, University of Georgia, Southeast Georgia Extension Center, P.O. Box 8112, Statesboro, GA 30460, <sup>2</sup>Screven County Extension, 321 Rocky Ford Rd., Sylvania, GA 30457, <sup>3</sup>Tattnall County Extension, P.O. Box 558, Reidsville, GA 30453, <sup>4</sup>Vidalia Onion and Vegetable Research Center, 8163 Highway 178, Lyons, GA 30436. (gboyhan@uga.edu)

**1:45 pm Specialty Eggplants (*Solanum melongena* L.) Yield Well in Mississippi Using Organic or Inorganic Production Methods.**

W.B. Evans\*, L.E. Rayburn, N. Winter and C.E. Coker. Mississippi State University Truck Crops Branch, P.O. Box 231, Crystal Springs, MS 39059-0231. (wbe@ra.msstate.edu)

**2:00 pm Break**

**2:15 pm Dimethyl Disulfide Use for Bacterial Wilt Management and Weed Control in Virginia Tomatoes.**

Josh Freeman\*, Steve Rideout and Adam Wimer. Virginia Tech Eastern Shore AREC, 33446 Research Drive, Painter, VA 23420. (joshfree@vt.edu)

**2:30 pm Fungicide Efficacy Studies on Leafy Greens.**

Juan R. Anciso, Department of Horticultural Sciences, Texas AgriLife Extension Service, Weslaco, Texas 78596. (j-anciso@tamu.edu).

**2:45 pm Field Trials of the Tissue Culture Taro in the Northern Mariana Islands.**

Dilip Nandwani, Crop Improvement Cooperative Research Extension and Education Service (CREES), Northern Marianas College, P.O. Box 501250, Saipan MP 96950, Northern Mariana Islands. (dilipnandwani@yahoo.com)

**Concurrent Afternoon Session B**

**Room: International Room E**

**Presiding: TBA**

**1:00 pm An Economical Analysis of Nutrient Management Programs for Fresh**

**Market Tomatoes Grown with**

**Plasticulture in the BMP Era.** Aparna Gazula\*, Eric Simonne, Fritz Roka, George Hochmuth, Michael Dukes and Peter Nkedi-Kizza, Horticultural Sciences Department, 1241 Fifield Hall, P.O. Box 0690, Gainesville, FL 32611-0690. (esimonne@ufl.edu)

**1:15pm Ionic Interferences to Nitrate and Potassium Analyses with Ion-selective Electrodes.**

Francesco Di Gioia\*, Eric H. Simonne, M. Gonnella, P. Santamaria, Aparna Gazula and Zenyth Sheppard, Horticultural Sciences Department, 1241 Fifield Hall, P.O. Box 0690, Gainesville, FL 32611-0690. (esimonne@ufl.edu)

**1:30 pm Advantages and Limits of Integrating Forecasts of El Nino Southern Oscillation (ENSO) has into Fertilizer Recommendations.**

Eric. H. Simonne\*, Clyde W. Fraisse and Zhengjun Hu, Horticultural Sciences Department, 1241 Fifield Hall, P.O. Box 0690, Gainesville, FL 32611-0690. (esimonne@ufl.edu)

**1:45 pm Determining Optimum Nitrogen Rates for Sweet Corn in Georgia.**

Josh Mayfield\* and W.T. Kelley. University of Georgia, Tifton Campus, P.O. Box 748, Tifton, GA 31793. (joshmay@uga.edu)

**2:00 pm Break**

**2:15 pm Can Alternate N Sources and Additives Reduce Nutrient Costs in Vegetables?**

W.T. Kelley\* and Denne Bertrand. University of Georgia, Tifton Campus, P.O. Box 748, Tifton, GA 31793. (wtkelley@uga.edu)

**2:30 pm Does Granular Preplant Nitrogen Source Influence a Staked Tomato (*Lycopersicon esculentum* Mill.) Crop?**

W.B. Evans\*, L.E. Rayburn and P.M. Hudson. Mississippi State University Truck Crops Branch, P.O. Box 231, Crystal Springs, MS 39059-0231. (wbe@ra.msstate.edu)

**2:45 pm Phosphorus Nutrition of Romaine Lettuce in North Carolina.**

Christopher C. Gunter<sup>1\*</sup>, Jose Garzon<sup>1</sup> and Bill Jester<sup>2</sup>, <sup>1</sup>1230 Kilgore Hall, Box 7609, Department of Horticultural Science, North Carolina State University, Raleigh, NC 27695-7609, <sup>2</sup>2202 Cunningham Road, Department of Horticultural

Science, North Carolina State University,  
Kinston, NC 28501.  
(chris\_gunter@ncsu.edu)

## FRUIT CROPS SECTION

**Room:** International Room G  
**Presiding:** Eric Stafne  
**Abstracts:** To publish abstract in *HortScience*, see instructions at end of program. Submit on disk at meeting or email to Chair: (eric.t.stafne@okstate.edu)

### Morning Session

**8:00 am Preliminary Studies of Pruning Primocane Blackberries and Raspberries for Autumn Harvest Timing in a Sustainable and Organic Production System.** Curt R. Rom<sup>1\*</sup>, Heather Friedrich<sup>1</sup>, Jason McAfee<sup>1</sup>, Elena Garcia<sup>1</sup>, Christopher Vincent<sup>1</sup>, and Donn Johnson<sup>2</sup>, <sup>1</sup>316 Plant Science, Department of Horticulture, University of Arkansas, Fayetteville, AR 72701, <sup>2</sup>319 Agriculture Hall, Department of Entomology, Fayetteville, AR 72701. (crom@uark.edu)

**8:15 am Row Covers Increase Yield and Advance Season of Ripening of Primocane Fruiting Blackberry Genotypes in the North Carolina Mountains.** Gina Fernandez\*, Jim Ballington and Absalom Shank, Department of Horticultural Science, North Carolina State University, Box 7609, Raleigh NC, 27695. (gina\_fernandez@ncsu.edu)

**8:30 am Blackberry Cultivar Performance in Central Alabama.** Robert Boozer<sup>1\*</sup>, Elina Coneva<sup>2</sup>, and Jim Pitts<sup>1</sup>, Auburn University, <sup>1</sup>Chilton Research and Extension Center, P.O. Box 366, Clanton, AL 35045, <sup>2</sup>101 Funchess Hall, Department of Horticulture, Auburn University, Auburn, AL 36849. (boozert@auburn.edu)

**8:45 am Blueberry Fruit Quality and Antioxidant Capacity as Affected by Fruit Ripeness.** Donna A. Marshall\* and James M. Spiers, USDA-ARS, Thad Cochran Southern Horticulture Laboratory, Poplarville, MS, 39470. (donna.marshall@ars.usda.gov)

**9:00 am Status of the Developing Rabbiteye and Southern Highbush Blueberry Industry in South China in 2008.** David Creech\*, College of Forestry and Agriculture, Stephen F. Austin State University, Nacogdoches, TX 75962-3000. (dcreech@sfasu.edu).

**9:15 am Break**

**9:30 am Using Budgets to Identify Best Practices: A Case Study in Organic Apples** German Rodriguez<sup>1</sup>, Jennie Popp<sup>1\*</sup>, Curt Rom<sup>2</sup> and Heather Friedrich<sup>2</sup>, <sup>1</sup>217 Agricultural Hall Department of Agricultural Economics and Agribusiness, <sup>2</sup>316 Plant Science, Department of Horticulture, University of Arkansas, Fayetteville, AR 72701. (jhpopp@uark.edu)

**9:45 am The Effects of Ground Cover Management Systems on Weed Density and Rodent Damage in a Sustainable and Organic Apple Orchard.** Curt R. Rom<sup>1\*</sup>, Jason McAfee<sup>1</sup>, Heather Friedrich<sup>1</sup>, Hyun-Sug Choi<sup>1</sup>, Donn Johnson<sup>2</sup>, and Elena Garcia<sup>1</sup>, <sup>1</sup>316 Plant Science, Department of Horticulture, University of Arkansas, Fayetteville, AR 72701, <sup>2</sup>319 Agriculture Hall, Department of Entomology, Fayetteville, AR 72701. (crom@uark.edu)

**10:00 am Effect of Aminoethoxyvinylglycine (AVG) on Fruit Size and Quality of Peaches.** Elina Coneva<sup>1\*</sup> and J. Pitts<sup>2</sup>, <sup>1</sup>101 Funchess Hall, Department of Horticulture, Auburn University, Auburn, AL 36849, <sup>2</sup>Auburn University, Chilton Research and Extension Center, P.O. Box 366, Clanton, AL 35045. (edc0001@auburn.edu)

**10:15 am Learning from Model Species: A Case Study of Comparative Genomics in *Arabidopsis*, *Populus*, Peach, and Apricot.** Sergio Jimenez<sup>1\*</sup>, Zhigang Li<sup>1</sup>, Amy L. Lawton-Rauh<sup>2</sup>, Gregory L. Reighard<sup>1</sup>, Albert G. Abbott<sup>2</sup> and Douglas G. Bielenberg<sup>1,3</sup>, <sup>1</sup>Department of Horticulture, Clemson University, Clemson, SC 29634-0319 U.S.A., <sup>2</sup>Department of Genetics & Biochemistry, Clemson University, Clemson, SC 29634-0318 U.S.A., <sup>3</sup>Department of Biological Sciences, Clemson University, Clemson,

SC 29634-0314 U.S.A.  
(sergij@clemson.edu)

**10:30 pm** Break to attend SR-ASHS Business Meeting at 11:00-12:30 and lunch

### Afternoon Session

**1:00 pm** **Mississippi Muscadines: Cultivar Performance and Properties.** Stephen J. Stringer\*, Donna A. Marshall, and James M. Spiers, USDA-ARS, Thad Cochran Southern Horticulture Laboratory, Poplarville, MS, 39470. (stephen.stringer@ars.usda.gov)

**1:15 pm** **Comparison of Field Grown Grapevine Stomatal Conductance Measurements using Differing Porometers.** Thayne Montague\*, Edward Hellman, and Michael Krawitzky. Texas AgriLife Research and Extension Center, Lubbock, Texas, U.S.A. 79403-6603, Department of Plant and Soil Science, Texas Tech University, Lubbock, Texas, U.S.A. 79409-2122 (thayne.montague@ttu.edu)

**1:30 pm** **Crop Load Affects Crown Gall Expression in ‘Cabernet Sauvignon’ after the 2007 Spring Freeze.** Eric T. Stafne\* and Becky L. Carroll, Department of Horticulture and Landscape Architecture, Oklahoma State University, Stillwater, OK 74074. (eric.t.stafne@okstate.edu)

## FLORICULTURE, ORNAMENALS AND TURF SECTION

**Room:** International Room E

**Presiding:** Ed Bush

**Abstracts:** To publish abstract in *HortScience*, see instructions at end of program. Submit on disk at meeting or email to Chair: (ebush@agctr.lsu.edu)

**8:00 am** **The effects of transplant timing from plug flats grown under short days with respect to the beginning of vernalization on plant size, flowering time, and product quality of *Achillea* × ‘Coronation Gold’.** J. Raymond Kessler, Jr.\* and Gary J. Keever, Department of Horticulture, Auburn University, AL 36849. (kessljr@auburn.edu)

**8:15 am** **National Earth Kind Rose Cultivar Trial in Louisiana: Blackspot Observations from 2007 and 2008.** Allen Owings<sup>1\*</sup> and C. Allen Broyles<sup>2</sup>. <sup>1</sup>LSU AgCenter, Hammond Research Station, 21549 Old Covington Highway, Hammond, LA 70403, <sup>2</sup>LSU AgCenter, Burden Center, 4560 Essen Lane, Baton Rouge, LA 70809. (aowings@agcenter.lsu.edu)

**8:30 am** **New Liriope Cultivar Evaluations in the Landscape.** Allen Owings, Yan Chen and Regina Bracy. LSU AgCenter, Hammond Research Station, 21549 Old Covington Highway, Hammond, LA 70403. (aowings@agcenter.lsu.edu)

**8:45 am** **Reproductive Biology of *Elliottia racemosa*, a Rare Coastal Plain Endemic.\*** Carrie A. Radcliffe\*, James A. Affolter, and Hazel Y. Wetzstein. Department of Horticulture, 1111 Miller Plant Science Building, University of Georgia, Athens, GA 30602-7273. (hywetz@uga.edu)

**9:00 am** Break

**9:15 am** **An Overview of the Significant Woody Ornamental Collections in the SFA Mast Arboretum.** Dave Creech, College of Forestry and Agriculture, Stephen F. Austin State University, Nacogdoches, TX 75962-3000. (dcreech@sfasu.edu)

**9:30 am** **Anti-cancer Activity of phenolic compounds in several medicinal herbs.** \* Weiguang Yi and Hazel Y. Wetzstein. Department of Horticulture, 1111 Miller Plant Science Building, University of Georgia, Athens, GA 30602-7273. (hywetz@uga.edu)

**9:45 am** **Urban Landscape Restoration In Post-Katrina New Orleans.** \*Ed Bush, Karen Blackburn and Kiki Fontenot.. 137 J. C. Miller Hall, Baton Rouge LA. 70803. (ebush@agctr.lsu.edu)

## POST HARVEST/PLANT BIOTECHNOLOGY SECTION

**Room:** Tower Room 1403

**Presiding:** Elizabeth Baldwin

**Abstracts:** To publish abstract in *HortScience*, see instructions at end of program. Submit

on disk at meeting or email to Chair:  
(ebaldwin@citrus.usda.gov)

- 8:00 am Introduction to the Session, Use of Enose to Determine Mango Maturity.** Elizabeth Baldwin, USDA-ARS Citrus & Subtropical Products Laboratory, 600 Ave. S N.W., Winter Haven, FL 33881. (Liz.Baldwin@ars.usda.gov)
- 8:15 am Quality of Four Basil Types after Storage at 3 to 10 °C.** Penelope Perkins-Veazie<sup>1\*</sup>, Angela Davis<sup>1</sup>, and Niels Maness<sup>2</sup>, <sup>1</sup>USDA-ARS, South Central Agricultural Research Lab, USDA-ARS, P.O. Box 159, Hwy. 3 West, Lane, OK 74555; <sup>2</sup>Oaklahoma State University. (pperkins-USDA@lane-ag.org)
- 8:30 am Quality of Organically Grown Cherry Tomatoes for the Oklahoma Farm to School Program.** Penelope Perkins-Veazie<sup>1\*</sup>, Angela Davis<sup>1</sup>, and Niels Maness<sup>2</sup>, <sup>1</sup>South Central Agricultural Research Lab, USDA-ARS, P.O. Box 159, Hwy. 3 West, Lane, OK 74555; <sup>2</sup>Oaklahoma State University. (pperkins-USDA@lane-ag.org)
- 8:45 am Assessment of Edible Coatings for Fresh Peach Slices.** Kathy Taylor<sup>1\*</sup> and Elizabeth Baldwin<sup>2</sup>, <sup>1</sup>Southerastern Fruit and Tree Nut Laboratory, 21 Dunbar Road, Byron, GA 31008; <sup>2</sup>USDA-ARS Citrus & Subtropical Products Laboratory, Winter Haven, FL 33881. (kctaylor@uga.edu)
- 9:00 am Various Foliar Potassium Fertilization Sources on Field-Grown Muskmelon: Effects on Yield and Market Quality.** Gene Lester<sup>1</sup> and John Jifon<sup>2</sup>, <sup>1</sup>USDA-ARS Kika de Garza Subtropical Agricultural Research Center, 2413 E. U.S. Hwy 83, Weslaco, TX 78596; <sup>2</sup>Texas A&M AgriLife Sciences, Weslaco, TX.. (Gene.Lester@ars.usda.gov)
- 9:15 am Break**
- 9:30 am Gene Expression Changes in Ripening Tomato.** Dan MacLean, University of Georgia, 4604 Research Way, Tifton, GA 31793. (dmaclean@uga.edu)
- 9:45 am Response of the Ascorbate-Glutathione Cycle and Lipoxygenase Pathway to Chilling and Heating Treatments in Tomatoes.** Jinhe Bai<sup>1\*</sup>, Yoshihiro Imahori<sup>1</sup> and Elizabeth Baldwin<sup>1</sup>, <sup>1</sup>USDA-ARS Citrus & Subtropical Products Laboratory, 600 Ave. S N.W., Winter Haven, FL 33881; <sup>2</sup>Osaka Prefecture University, Osaka, Japan. (Jinhe.Bai@ars.usda.gov)
- 10:00 am Evaluation of Fruit Quality Characteristics of ‘Early Pride’, a New Seedless Mandarin from the USDA-ARS.** Greg McCollum, USDA-ARS Horticultural Research Laboratory, 2001 South Rock Road, Ft. Pierce, FL 34945. (Greg.McCollum@ars.usda.gov)
- 10:15 am Quality Evaluation of Newly Released Florida Strawberries by Sensory Analysis.** Celine Jouquand<sup>1</sup>, Anne Plotto<sup>1</sup> and Craig Chandler<sup>2</sup>, <sup>1</sup>USDA-ARS Citrus & Subtropical Products Laboratory, 600 Ave. S N.W., Winter Haven, FL 33881; <sup>2</sup>University of Florida Gulf Coast Research and Education Center, 14625 CR 672, Wimauma, FL 33598.
- 10:30 am Cultivar Variability in the Response of Tomato Fruit Lycopene Synthesis to a Brief Postharvest Heat Stress.** Jeffrey K. Brecht<sup>\*</sup>, Artemio Z. Tulio, Keethi Cherukuri, Amarat H. Simonne, and M. Celiia N. Nunes, University of Florida, 1301 Fifield Hall, Gainesville, FL 32611. (jkbrecht@ufl.edu)

# Instructions for Submission of Abstracts for Publication in *HortScience*

## To Publish Your Abstract in *HortScience*:

- 1) One of the authors must be an active member (dues paid) of the Southern Region ASHS
- 2) The abstract must be submitted as a document file in the proper format.
- 3) The abstract must be submitted to the Chair of the session by the deadline.

## Submission of Abstract

**File Format:** Each abstracts must be submitted as a separate Word (.doc) file. If you use another word processing language, submit abstract in rich text format (.rtf).

**Deadline:**

- 1) At meeting: Give disk with file to the Chair of the session.
- 2) Email abstracts as an attached file to the Chair of the session within a few days after the meeting. See the Section Program for the Chair's email address.

## Abstract Format

**Length:** Limit the abstract body to about 2000 characters.

**Font:** 12 point, Times New Roman or similar

**Format:** Format abstract as below. Asterisk denotes presenting author.

## Example Format

### **Molecular Marker-Derived Genetic Similarity Analysis of a Segregating Blackberry Population**

Eric T. Stafne\*<sup>1</sup>, John R. Clark<sup>1</sup>, and Kim S. Lewers<sup>2</sup>

<sup>1</sup>316 Plant Sciences, Department of Horticulture, University of Arkansas, Fayetteville, AR 72701, <sup>2</sup>USDA-ARS Fruit Lab, 10300 Baltimore Ave., BARC-West Bldg. 010A, Beltsville, MD 20705

A tetraploid blackberry population that segregates for two important morphological traits, thornlessness and primocane fruiting, was tested with molecular marker analysis. Both randomly amplified polymorphic DNA (RAPD) and simple sequence repeat (SSR) markers were used to screen a population of 98 genotypes within the population plus the two parents, 'Arapaho' and 'Prime-Jim'<sup>®</sup> (APF-12). RAPD analysis averaged 3.4 markers per primer, whereas SSR analysis yielded 3.0 markers per primer pair. Similarity coefficient derived from the Dice index averaged over all individuals was 63% for RAPD markers, 73% for SSR markers, and 66% for RAPD and SSR markers together. The average similarity coefficients ranged from a high of 72% to a low of 38% for RAPD markers, 80% to 57% for SSR markers, and 73% to 55% for both. Comparison of the parents indicated a similarity of 67% for RAPD markers, 62% for SSR markers, and 67% for both. This is similar to a previous study that reported the similarity coefficient at 66%. Although inbreeding exists within the population, the level of heterozygosity is high. Also, evidence of tetrasomic inheritance was uncovered within the molecular marker analysis. This population will be used to identify potential markers linked to both morphological traits of interest. Further genetic linkage analysis and mapping is needed to identify any putative markers.



# NOTES

## Program at a Glance Saturday

Westin Peachtree	8:00				9:00				10:00				11:00				12:00				1:00				2:00				3:00				4:00				5:00																											
Hotel Lobby	7:00 open																																Registration																															
International Room E	Pecan Research & Extension Forum																																																															
International Room F	National Sweetpotato Collaborators																																																															
International Room G	Southern Blueberry/Small Fruit Workers																																																															
Boardroom																									Horticulture Administrators								Executive Com.																															
International Room B	ACB, Club Share								ACB Group Lunch								ACB Activities or Tour								ACB Reception																																							

## Sunday

Westin Peachtree	8:00				9:00				10:00				11:00				12:00				1:00				2:00				3:00				4:00				5:00																											
International Balcony	7:00 open																																Registration																															
The Overlook Room	Poster Session Set-Up																Viewing				Authors Even #		Authors Odd #		Student Judging				Viewing																																			
Agusta I	J. Benton Storey Horticulture Judging Contest Set-Up																J. Benton Storey Horticulture Judging Contest																																															
International Room G	Extension Section																Education Sect.																																															
International Room F	National Sweetpotato Collaborators																																																															
International Room D	Watermelon Research Group																																																															
International Room E	Edmond UG Paper Comp.				Childers M.S. Paper Competition												Barham Ph.D. Paper Comp.																																															
International Room C	Vigna Crop Germplasm Committee												National Cowpea Improvement Association																																																			
Vinings 1 & II	SAAS Renewable Energy																																																															
Peachtree Ballroom	Super Bowl Prty.																																																															

## Monday

Westin Peachtree	8:00				9:00				10:00				11:00				12:00				1:00				2:00				3:00				4:00				5:00																											
International Balcony	7:00 open																																Registration																															
The Overlook Room	Poster Session Viewing																Take Down																																															
International Room D	ACB Business Meeting								Business Meeting/Awards Prog.																																																							
International Room F	Vegetable Crops Section																Vegetable Crops Section																																															
International Room E	Floriculture, Orn. & Turf Section																Vegetable Crops Section																																															
International Room G	Fruit Crops Section																Fruit Crops Section																																															
Tower Room 1403	PostHarvest & Biotechnology Section																																																															
Vinings Rooms	SAAS Symp. - Where has all the Money Gone																Technical/Academic Papers								Take it to the Market																																							

# Meeting Room Locations

The Westin Peachtree Plaza

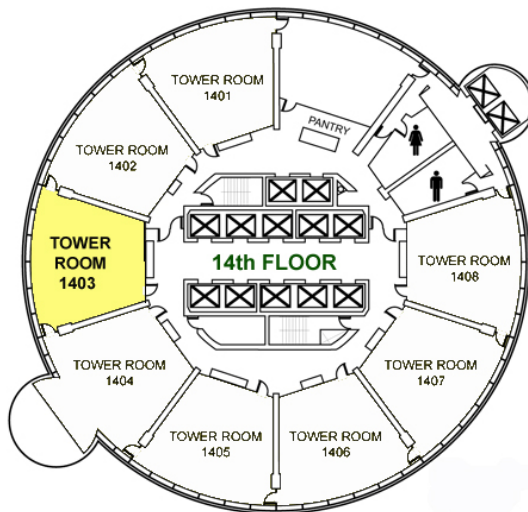
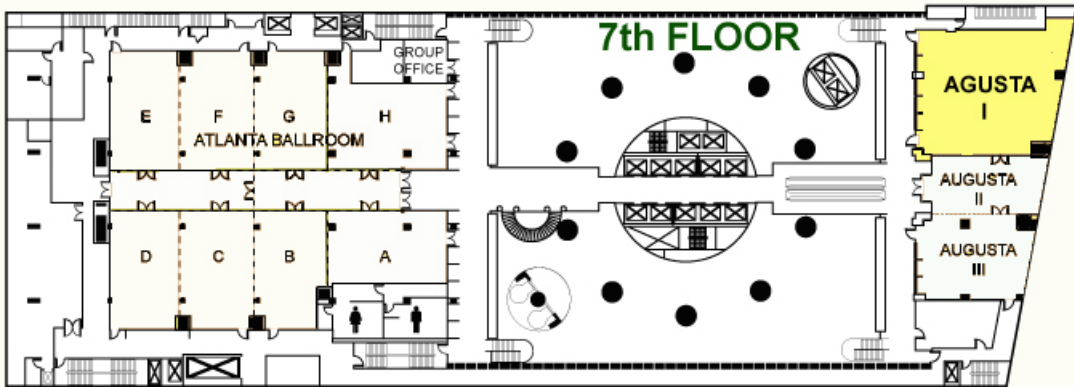
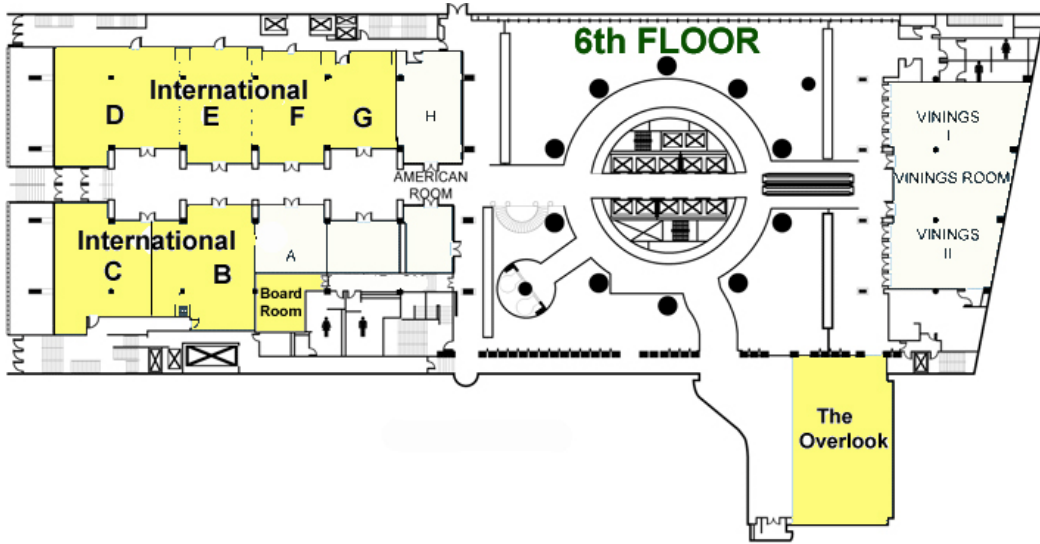

# ASHS Annual Conference

St. Louis, Missouri

25–28 July 2009



Photo courtesy of the St. Louis Convention & Visitors Commission.

Join your colleagues at the beautiful Millennium Hotel  
situated on the banks of the Mississippi River

American Society for Horticultural Science

113 South West Street, Suite 200, Alexandria, VA 22314-2851

phone: 703.836.4606 • fax: 703.836.2024 • [ashs.org](http://ashs.org) • [meetings@ashs.org](mailto:meetings@ashs.org)